

Is there an inverter in the photovoltaic prefabricated cabin

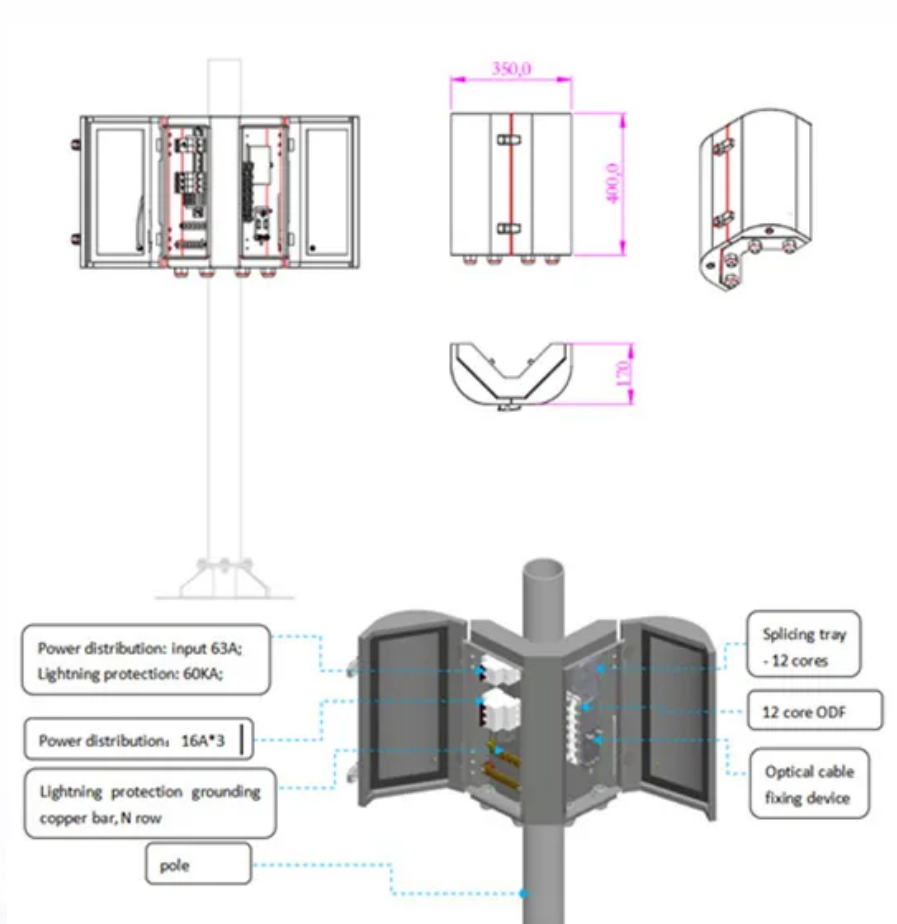

Overview

A New Energy Integrated Photovoltaic Prefabricated Cabin is a modular, preassembled structure equipped with solar panels, energy storage systems, inverters, and control units.

Is there an inverter in the photovoltaic prefabricated cabin



Their vs. There

When do we use "there"? While "their" is a seemingly simple word, with two distinct uses and a clear meaning, "there" is a little bit more complex, in regard to the contexts where it may appear. To be

There: Definition, Meaning, and Examples

There (interjection): Used for emphasis or reassurance. The word "there" can refer to a place, be used to introduce a sentence, or act as a filler when stating something exists.



Transformation cabin

It can be supplied as a centralized inverter or as a string inverter, for large photovoltaic plants. Transportation methods: It can be lifted from lifting brackets

[there, adv., n., & int. meanings, etymology and more , Oxford English](#)

There are 27 meanings listed in OED's entry for the word there, six of which are labelled obsolete. See 'Meaning & use' for definitions, usage, and quotation evidence.



[YZC New Energy Integrated Photovoltaic Prefabricated Cabin](#)



Custom Wholesale New Energy Integrated Photovoltaic Prefabricated

A New Energy Integrated Photovoltaic Prefabricated Cabin is a modular, preassembled structure equipped with solar panels, energy storage systems, inverters, and control units.



New Energy Integrated Prefabricated Chamber , Substation

NSYZC new energy integrated prefabricated chamber for photovoltaic and power systems, modular design with transformer, inverter, and switchgear in one unit.



The entire enclosure is constructed using a container shell, containing a transformer compartment, high-voltage compartment, communication/power cabinet compartment, and inverter compartment.



"Their" vs. "There" vs. "They're": What's the Difference?

In this article, we'll explain the meanings of their, there, and they're, how to use each word correctly, and provide example sentences for each term. We'll also give some tips on how to



There: different ways of using 'there' in English, Learn English Today

English Grammar THERE The different ways of using 'there'. There is used as an adverb of place, to indicate the location of something. There can also be used in several other ways. Here are some

[There Definition & Meaning , YourDictionary](#)

Used to introduce a clause or sentence. There are numerous items. There must be another exit.



[YZC New energy integrated photovoltaic prefabricated](#)

The container shell is equipped with ventilation louvers, fan outlet and fan for internal and external air circulation of the whole box. The inverter room is

THERE , English meaning

We can use there at the start of a clause as a type of indefinite subject. This means that we can put the actual subject at the end of the clause and so give it emphasis or focus (underlined below):



[New Energy Integrated Photovoltaic Prefabricated Cabin MV&HV](#)

YZC New Energy Integrated Photovoltaic Prefabricated Cabin, European style Integrated Machine.

NEW ENERGY INTEGRATED PHOTOVOLTAIC

YZC New Energy Integrated Photovoltaic Prefabricated Cabin, European style Integrated Machine.





[Inverter cabins for wind photovoltaic systems](#)

In the inverter prefabricated substation there is a local inverter containing a conversion unit. The inverters are not provided with internal transformer, so the alternating voltage output will be that of

[Prefabricated Photovoltaic Cabins for Industrial and Utility-Scale](#)

Prefabricated photovoltaic cabins are not just protective enclosures; they also house integrated electrical and control systems. This includes inverters, circuit breakers, sensors, and



THERE Definition & Meaning

Note: Do not confuse there, which has meanings that mostly relate to a literal or abstract location, with the words their and they're. Their has to do with what belongs to or is associated with them (" their

Photovoltaic Prefabricated Cabin_OLE

Wind & PV systems convert DC power from solar panels into AC power via inverter for direct integration into public grids. The Distributed Wind/PV On-grid Cabin serves as the core solution in this process,



Contact Us

For off-grid system quotes, technical support, or partnerships, please visit:

<https://kephamatraining.co.za>